

FRONT VIEW

BEFORE BEGINNING INSTALLATION, READ ALL INSTRUCTIONS

INSTALLATION INSTRUCTIONS

- 1- REMOVE THE EXISTING SUN VISOR.
- 2- REDRILL EXISTING HOLES TO 1/2 in. AND INSERT WELLNUTS.
- 3- INSTALL THE BRACKETS ONTO THE CAB.
- 4- TEMPORARILY INSTALL THE SUN VISOR AS ILLUSTRATED
- 5- USING THE SUN VISOR, MARK OUT HOLES ON BOTH ENDS OF SUN VISOR.

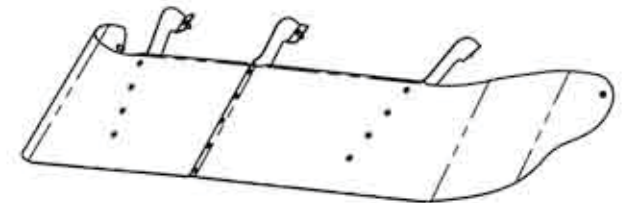

ATTENTION

REMOVE SUN VISOR TO PREVENT DAMAGE

- 6- DRILL THE PREVIOUSLY MARKED OUT HOLES AT 1/2 IN. DIA.
- 7- INSERT THE WELLNUTS.
- 8- REINSTALL THE SUN VISOR ON THE CAB.
- 9- TIGHTEN ALL BOLTS AND SCREWS FIRMLY.

TRUX ACCESSORIES

TITLE:
SUN VISOR HIGH ROOF
PETERBILT 387, 2000 & UP

SIZE DWG. NO.
A **TSUN-P28**

NAME	DATE	REV	DATE
DRAWN BY P.W.	26-29-2008	PH1	-
SCALE: 1:24	WEIGHT: LBS	SHEET: 1 OF 1	

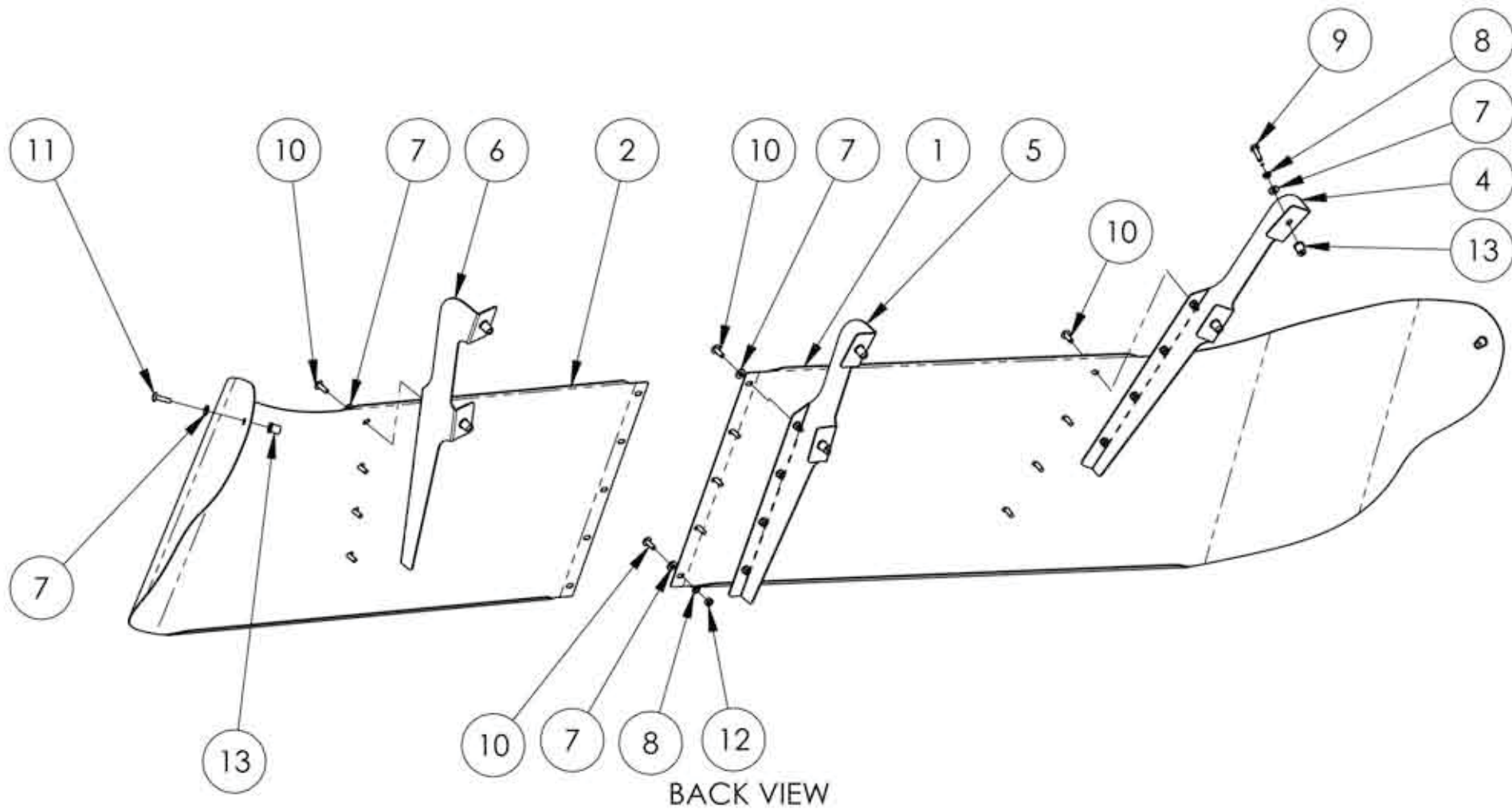

ITEM NO.	PART NO.	DESCRIPTION	QTY
1	M7131014SD	SUN VISOR PANEL	1
2	M7131014SG	SUN VISOR PANEL	1
3	K7131014BH	HARDWARE KIT INCLUDE:	
4	-	PR9131014-D00	1
5	-	PR9131014-C00	1
6	-	PR9131014-G00	1
7	-	FLAT WASHER 1/4" SS	21
8	-	LOCK WASHER 1/4" SS	19
9	-	HEX BOLT 1/4NC X 1	6
10	-	TRUSS PHILIPS 1/4" X 3/4" SS	13
11	-	TRUSS HEAD SCREW 1/4NC X 1	2
12	-	HEX NUT 1/4-20NC	13
13	-	WELL NUT 1/4"-20NC	8

TRUX ACCESSORIES

TITLE:
SUN VISOR HIGH ROOF
PETERBILT 387, 2000 & UP

SIZE DWG. NO.
A **TSUN-P28**

NAME	DATE	REV	DATE
DRAWN BY: P.W.	26-29-2008	PH1	-

SCALE: 1:10 WEIGHT: LBS SHEET: 1 OF 1